



IMAGINATION STARTS HERE

FOLD & GO RIGID HEDDLE LOOM

Assembling Your Beka Fold & Go Rigid Heddle Loom

Contents (left to right in photo):

- apron rod, back beam (or crossbar), warp beam with gear on one end, tie-on cord
- back sides with uprights and shed blocks (left & right), foot dowels and pawls (shown in center)
- hardware to connect back and front sides, wood knobs, short dowel stops, 1/2 gears (half moon pcs)
- front sides with uprights (left & right)
- fabric beam with gear on one end, front beam (or crossbar), apron rod
- rigid heddle (8 dent), threading tool & tie-on cord
- * Not shown: 2 Shuttles, 1 Pickup Stick

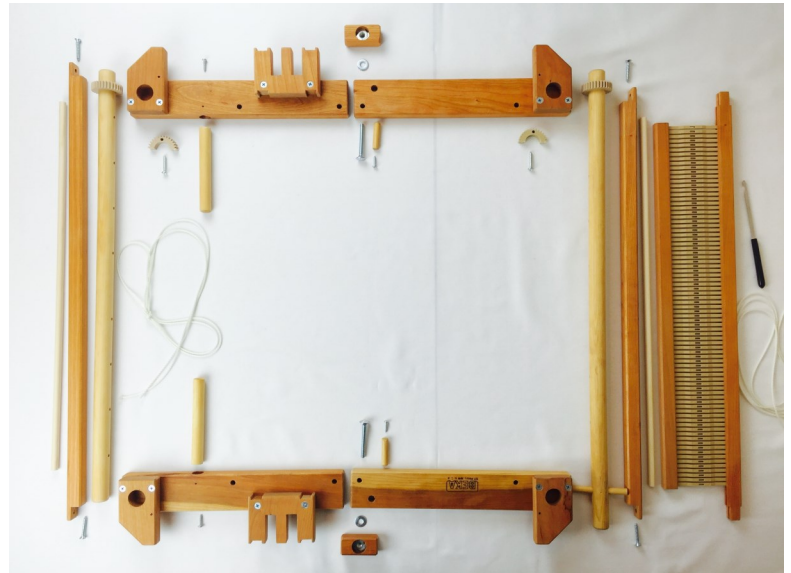

You will need a phillips screwdriver.
Read instructions completely before beginning.

Step 1:

Attach plastic pawls: Use 1" screws to fasten pawls (half moon pcs) to the right back side and right front side uprights (Step 1). Make sure screws allow easy movement of the pawls; pawls should easily pivot back and forth.

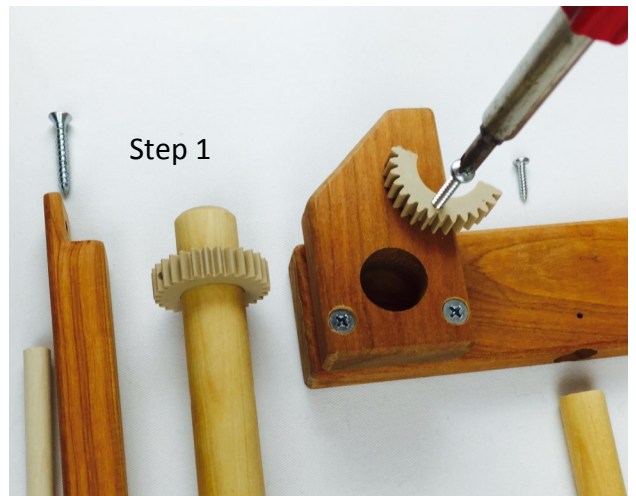

Step 2:

Insert and secure dowel stops; connect front and back side pieces: Push short dowels into "through" holes provided in each front side, so dowel end is flush with the outside surface; secure with small screws. Position back sides inside front sides with uprights and shed blocks "inside" the loom frame (Step 2 shows connected right sides; connected left sides are the mirror opposite). Slide carriage bolts through holes provided (from inside to outside of loom). Secure with washers and knobs outside the loom frame. Note: When oriented correctly, the large flat face of the metal knob inserts remain visible during use! Tighten knobs to "snug" - do not over-tighten.



Step 3: Position warp beam and longer fabric beam:

Slide beam ends into holes provided in four uprights. Beam ends with “gears” should be adjacent to the pawls (half moon/gear pieces) on loom’s right side pieces. The shorter beam goes across the back of the loom (resting in uprights attached to side pieces which have shed blocks). The longer beam goes across the front of the loom.

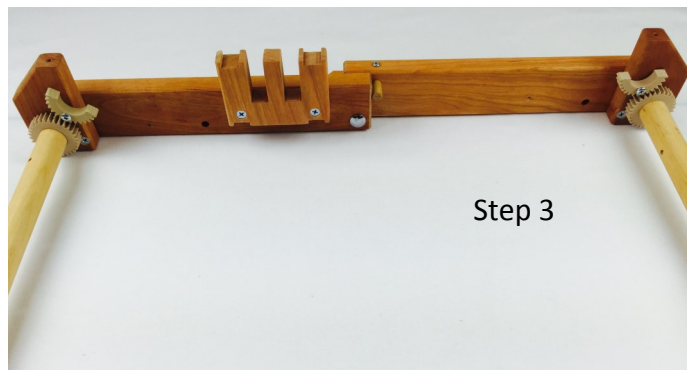

Step 3

Step 4:

Attach Cross Bars: The back beam (crossbar) is shorter; the front beam (crossbar) is longer. Position each crossbar so their notched ends rest on the flat areas at the top of each upright. Use the 1-1/4” screws provided to attach crossbars to the uprights.

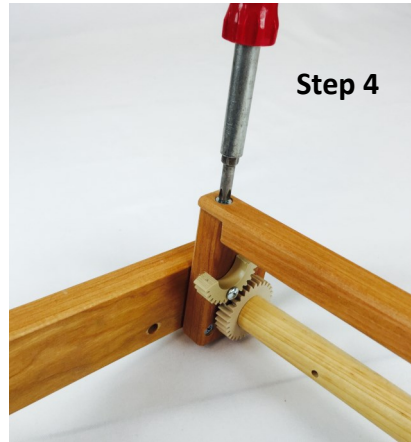

Step 4

Your Fold & Go Loom is almost ready to use!

Step 5:

Position foot dowels: Turn the assembled loom up-side down, to expose the large dowel holes in the bottom edge of the loom’s back side pieces. Slide foot dowels into the holes. Secure with small screws through small holes in the side pieces.



Step 5

Turn loom right-side-up.

You are ready to plan a project and warp your loom.

** The four unused holes in your loom’s sides are there to attach the optional Beka Floor Stand.

Warping and Weaving with your Fold & Go Loom

-Use of cord and apron rods will vary depending on your chosen warping technique. Cord may be used (as two long lengths or cut into short pieces) to tie apron rods with warp bundles to the warp and fabric beams. Cord may also be used to tie warp bundles directly to the warp and/or fabric beam.

-Rigid heddles will stand upright in the deep shed block notches during the warping process. Heddles will “stand” on their own after threading, held in place by the tension of the warp. During weaving, heddles may be used in an “up” shed, “down” shed, or “neutral” position. Notches are provided to help you locate various heddle positions.

Visit our web site to check out our "How to Weave" Terms & Tips Link:

<http://www.bekainc.com/images/stories/foldandgohowtoweave.pdf>



Assembled Fold & Go Loom with optional Floor Stand